

## INSTALLATION

### 1. INSTALL WATER PUMP

- (a) Install a new gasket and the water pump with the 17 bolts.

**Torque:**

**9.0 N·m (92 kgf·cm, 80 in·lbf) for 10 mm (0.39 in.) head**

**23 N·m (235 kgf·cm, 17 ft·lbf) for 12 mm (0.47 in.) head**

### 2. INSTALL V-RIBBED BELT TENSIONER ASSY

(See page [EM-44](#))

### 3. INSTALL COOLER COMPRESSOR

(See page [EM-108](#))

### 4. INSTALL GENERATOR (See page [CH-15](#))

### 5. INSTALL IDLER PULLEY

- (a) Install the 2 idler pulleys with the 2 bolts.

**Torque: 39 N·m (398 kgf·cm, 29 ft·lbf)**

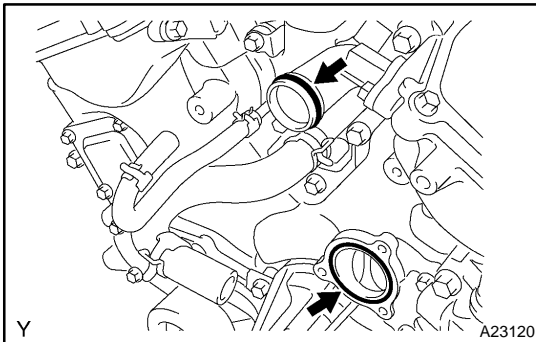

### 6. INSTALL WATER INLET

- (a) Install a new O-ring to the water outlet pipe.  
 (b) Install a new gasket to the water pump.  
 (c) Apply soapy water to the O-ring.

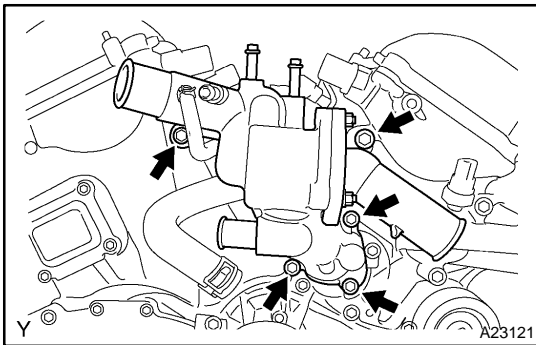

- (d) Install the water inlet with the 5 bolts.  
**Torque: 9.0 N·m (92 kgf·cm, 80 in·lbf)**  
 (e) Connect the 5 water by-pass hoses.  
 (f) Connect the 2 radiator hoses.  
 (g) Connect the 2 oil cooler hoses (w/ oil cooler).

### 7. INSTALL AIR CLEANER

### 8. CONNECT VENTILATION HOSE NO.2

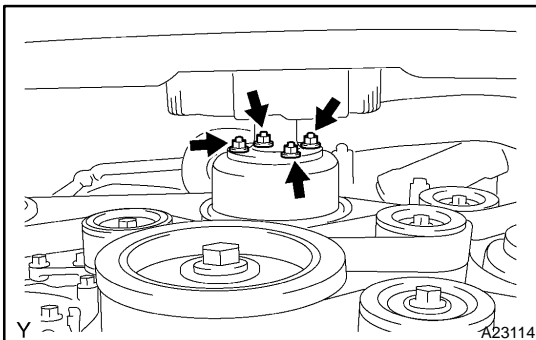

### 9. INSTALL FAN W/ FLUID COUPLING

- (a) Put the fan pulley to the water pump.  
 (b) Put the fan w/ fluid coupling and fan shroud together.  
 (c) Temporarily install the 4 fluid coupling nuts.  
 (d) Tighten the 4 fan shroud bolts.  
**Torque: 5.0 N·m (51 kgf·cm, 44 in·lbf)**  
 (e) Connect the reserve tank hose.  
 (f) Fasten the 2 oil cooler hoses with the hose clamp.

10. **INSTALL FAN AND GENERATOR V BELT**  
(See page [EM-89](#))
11. **FULLY TIGHTEN FAN W/ FLUID COUPLING**
  - (a) Tighten the 4 fluid coupling bolts.  
**Torque: 21 N·m (214 kgf·cm, 15 ft·lbf)**
12. **ADD ENGINE COOLANT (See page [CO-2](#))**
13. **CHECK FOR ENGINE COOLANT LEAKS**
14. **INSTALL ENGINE UNDER COVER**
  - (a) Install the engine under cover with the 4 bolts.  
**Torque: 29 N·m (296 kgf·cm, 21 ft·lbf)**
15. **INSTALL V-BANK COVER**
  - (a) Install the V-bank cover with the 2 nuts.  
**Torque: 9.8 N·m (100 kgf·cm, 87 in·lbf)**
16. **RECHECK ENGINE COOLANT LEVEL**
17. **FILL WITH ENGINE COOLANT**
18. **START ENGINE AND CHECK FOR ENGINE COOLANT LEAKS**
19. **RECHECK ENGINE COOLANT LEVEL**